

What's Inside

Please check the accessories after opening the package.

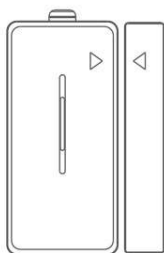

key fob remote x 1



door sensor x 1

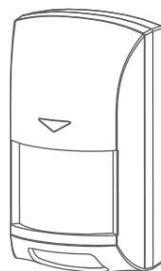

motion sensor x 1

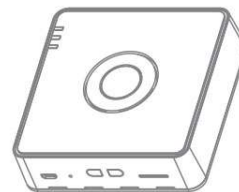

S2 hub x 1

Hub accessories



Expansion screw x 2
Bolt x 2



USB cable x 1



3M adhesive
sticker x 1

Door sensor installation accessories



3M adhesive
sticker x 2

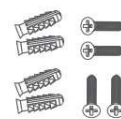

Expansion screw x 4
Bolt x 4

Motion sensor installation accessories

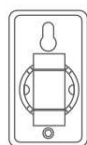

Holder base



Expansion screw x 2
Bolt x 2

Hub

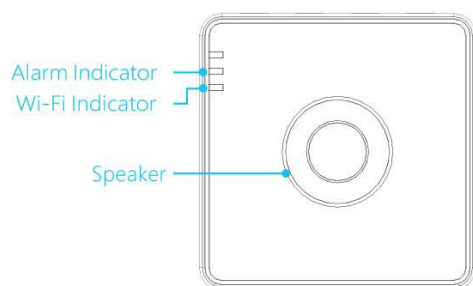

How to install

Configuration

Wi-Fi indicator flashes quickly
about 2-3 times/sec



- Please choose the proper adapter which output power is 5V DC and $\geq 1A$.

Specifications

Device name: S2 hub

Power input: DC 5V/1A Micro USB

Operating temperature: 0°C-50°C

Operating humidity: $\leq 85\%RH$

Standby consumption: <1W

Wi-Fi Standard: 2.4GHz 802.11 b/g/n

RF sensitivity: -110dB

RF frequency: 433.92 MHz

Max connections: 16 sensors

Device dimensions: 100x100x28mm

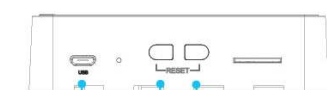

Power Input

Reset Button

* Device reset — Long press reset button for more than 6s until Wi-Fi indicator flashes.

Door Sensor

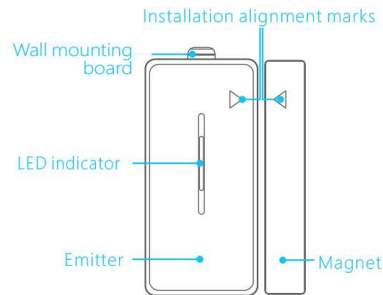

Specifications

Device name: Door Sensor
Power input: 3V battery (2x AAA)
Operating temperature: 0°C-50°C
Operating humidity: ≤85%RH
Standby consumption: ≤9uA
Operating consumption: ≤15mA
RF range: 30m (line-of-sight)
RF frequency: 433.92 MHz
Supported alerts: Burglary, tampering, low battery
Auto-report: Synchronize with hub every 60min with status
Device dimensions: 50x77x19mm

How to install

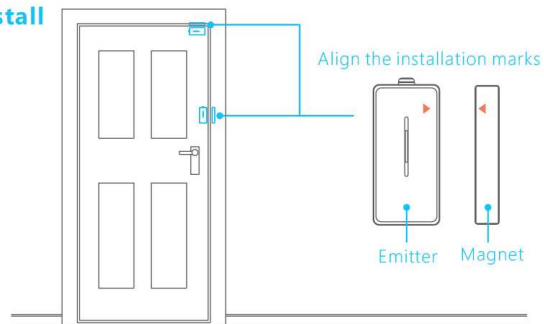

Motion Sensor

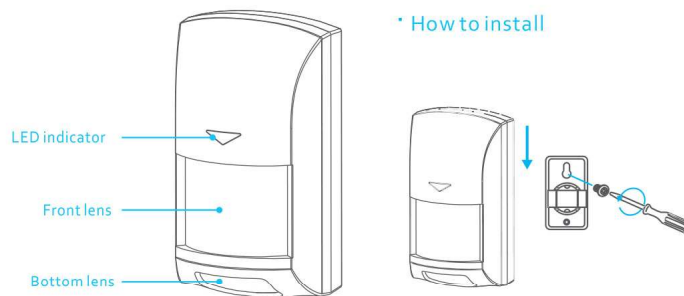

How to install

Specifications

Device name: Motion sensor
Power input: 3V battery (2x AA)
Operating temperature: 0°C-50°C
Operating humidity: ≤85%RH
Standby consumption: ≤15uA
Operating consumption: ≤15mA
RF range: 30m (line-of-sight)
RF frequency: 433.92 MHz
Detection range: ≤12m @25°C (typical)
Effective angle: 90°
Installation height: 2.2-2.7m
Device dimensions: 110x62x47mm

■ Key Fob Remote

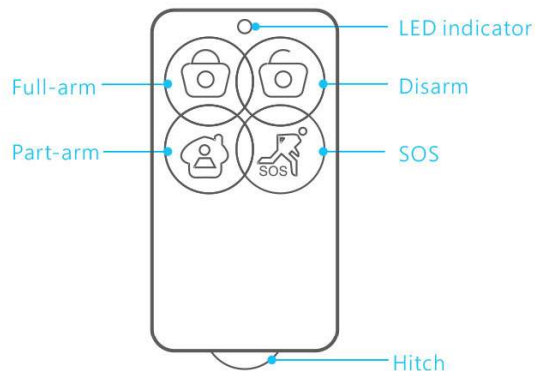

· Parameter

Device name: Key fob remote
Power input: 3V battery (1x CR2032)
Operating temperature: 0°C-50°C
Operating humidity: ≤85%RH
Standby consumption: ≤1uA
Operating consumption: ≤15mA
RF range: 30m (line-of-sight)
RF frequency: 433.92 MHz
Indication: Hold any button for 1s, the LED indicator flashes
Device dimensions: 58x31x10mm

■ Frequently Asked Questions

❓ What does the alarm kit do?

- The alarm kit can help you to monitor the occupancy of your home by door/window sensor and motion sensor. Any authorized entry will trigger the hub beeping and notify you on the app. It can be also used as trigger engine to automate scenes, for example when motion sensor detects person, turn on the lights.

❓ What are full-arm and part-arm?

- Full-arm is to set all sensors in alert mode. It is normally used when there is no one at home. Part-arm is to set selected sensors in alert mode. Only those "part-arm enabled" sensors will detect and send alert. Other sensors will not send alert but still work for other scene triggers. It is normally used when you are at home and minimal protection is required.

❓ How many sensors can be connected to a hub?

- Max 16 sensors

■ Note

- Do not use non-ASCII characters in Wi-Fi name or password. It may cause configuration failure. The device supports 2.4GHz Wi-Fi 802.11 b/g/n only.
- Please strictly follow the instructions on manual to use the devices;
- In case of problems, please contact the authorized resellers or service center.
- In case of specification change, the actual product information shall prevail.



Scan QR code to follow us on Facebook



key fob remote



door sensor



motion sensor